

Profile

- analog position indicator
- Measured value acquisition based on the gravity principle
- High stability thanks to doubly supported pointer shaft
- Very robust, glass-fiber reinforced plastic housing
- Wide range of gear ratios
- Special scales, also for small numbers of pieces
- Dustproof, oil-filled or waterproof versions

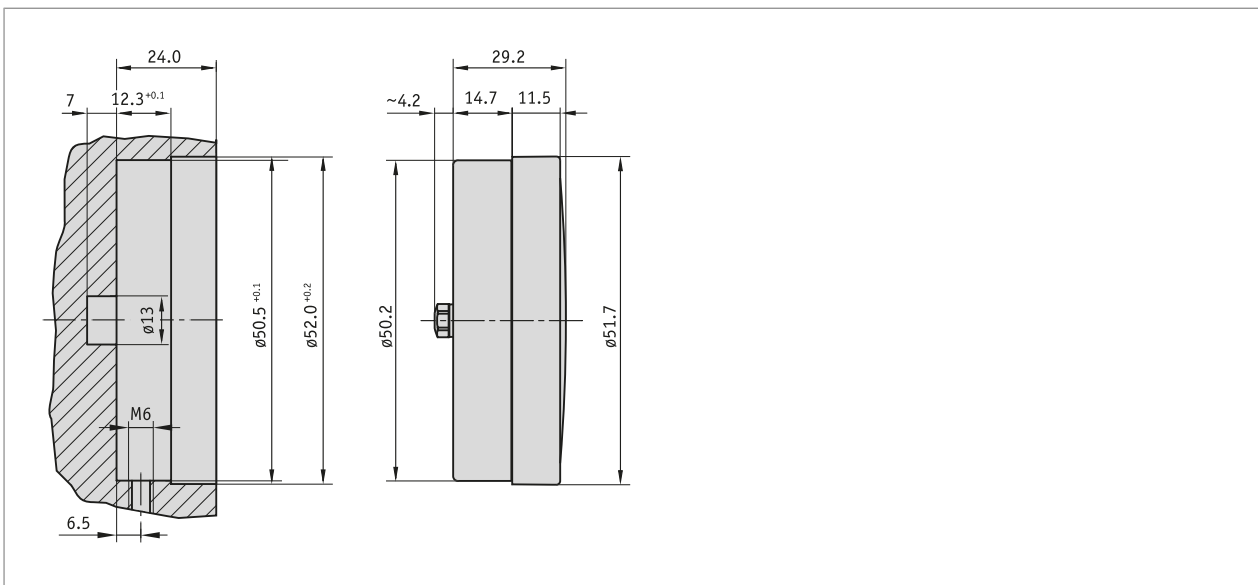

Mechanical data

Feature	Technical data	Additional information
Housing	reinforced plastic	
Weight	0.1 kg	N, W design
	0.1 kg	P design

Order

■ Ordering information

One or more system components are required:

Handwheel HG5	www.siko-global.com
Handwheel HR6	www.siko-global.com
Handwheel HST7	www.siko-global.com
Handwheel KHB9	www.siko-global.com

■ Ordering table

Feature	Ordering data	Spezifikation	Additional information
version	A		
	N	dust-proof	
	P	oil-filled	
	W	waterproof	

Analog position indicator S50/1

For small SIKO handwheels

Feature	Ordering data	Spezifikation	Additional information
Gear ratio	B ...	1, 2, 3, 6, 10, 12, 15, 18, 20, 24, 30, 36, 48, 50, 60, 72, 84, 96, 100 others on request	
Sense of rotation	C i	clockwise ascending values	
	e	counter-clockwise ascending values	
Pointer	D 1	red with transmission	
	2	red with transmission + black 1:1	
covering glass	E S	plastic	
	A	synthetic material, aceton-resistant	
scale	F N...	normal scale	related to the transformation ratio
	VK...	special scale	customer-specific, no VK for first production
multi-color scale	G C1	1-colored	
	C2	2-colored	
	C3	3-colored	

■ Order key

S50/1 - - - - - - -

A
B
C
D
E
F
G

 **Scope of delivery:**
S50/1